

**Outdoor  
Square  
Table**

**FOOD**

# Components

1x Table Top

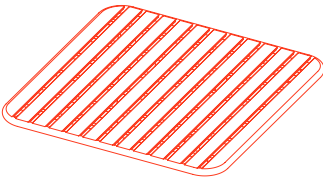

2x Leg Frames

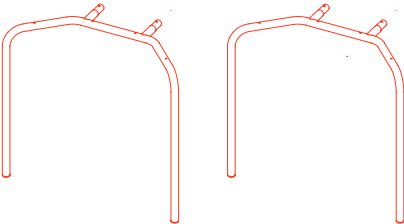

2x Connector Tubes



# Components Cont'd

12x Bolts



12x Washers



1x Hex Tool

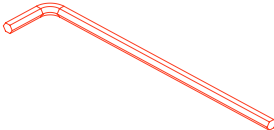

# 1

## Set up table legs

Insert the two recessed  
tubes on each leg frame into  
connector tubes.

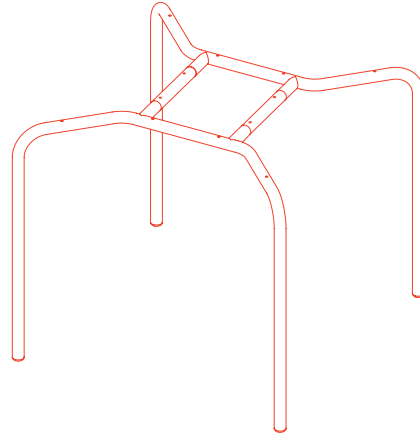
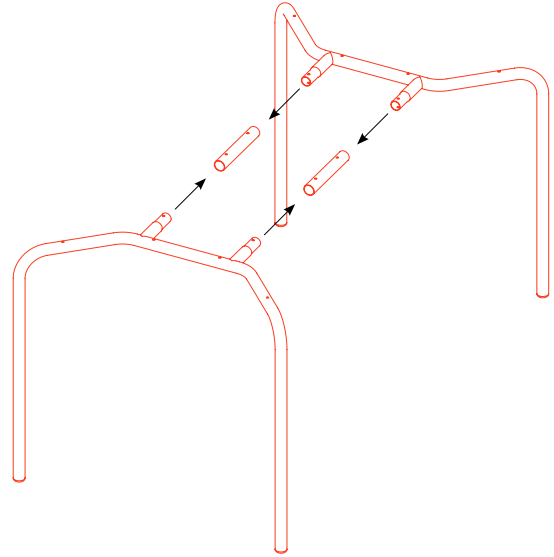

# 2

## Attach Table Top

Align the leg frames with the holes on the bottom of the table top and use the 12 provided bolts and washers to fasten the legs to the table top.

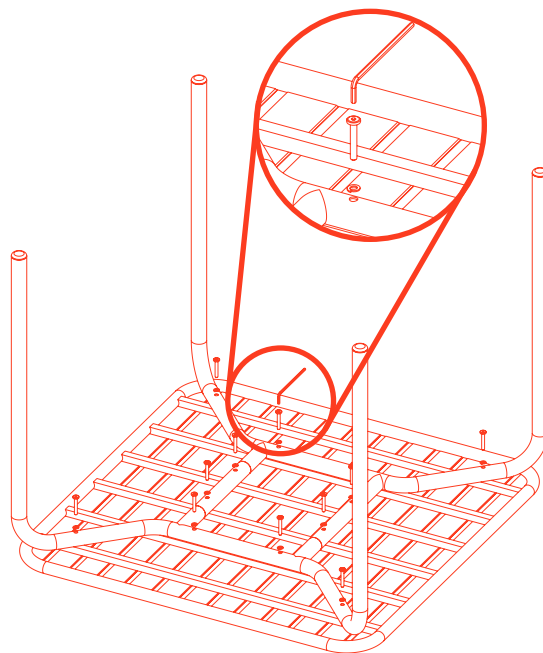

# 3

**Done!**

**Carefully flip table over.  
Double check that all bolts  
are tightened. Your table  
is now ready to use!**

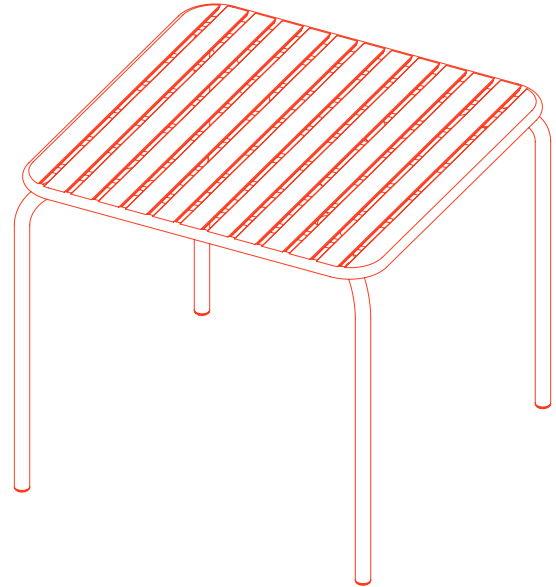

## WARNING ⚠

READ ALL INSTRUCTIONS **BEFORE** ASSEMBLY & USE. ADULT ASSEMBLY REQUIRED.  
KEEP SMALL PARTS AND PACKAGING AWAY FROM CHILDREN.

### NOTES ON USE:

Keep children and others safe by following these simple rules:

**Do not** allow any child to play on furniture

**Do not** allow climbing on any piece of furniture

**Do not** allow hanging from any piece of furniture

### ASSEMBLY:

Use extra caution when assembling and have someone assist you. Do not change the specifications or modify this product. Incorrect assembly can cause product to fail and cause personal injury. Double check that all fasteners are tightened before use. Have someone assist you when flipping over the product after assembly.

### USAGE

Remove all packaging before first use. Check periodically that all fasteners are securely tightened. Be aware that fasteners may become loose with prolonged use. Do not load the Outdoor Tables with more than 150 lbs. Do not stand on the Outdoor Tables. Standing or leaning on the Outdoor Tables may cause risk and personal injury. Use caution when moving or flipping the Outdoor Tables over. Failure to observe recommended practices such as loading beyond weight capacity can result in unsafe usage conditions and product damage or personal injury.

### CARE:

Clean surfaces with a dry or damp soft cloth. Do not use abrasive or oil based cleaners. Safe for indoor or outdoor use. Store indoors during extreme weather conditions.

## CONTACT

Have a question,  
comment, or suggestion?  
Just want to say hi?

[hello@floydhome.com](mailto:hello@floydhome.com)

## VISIT

The Floyd Shop  
1948 Division St. Suite 101  
Detroit, MI 48207

[FLOYDHOME.COM](http://FLOYDHOME.COM)

FLOYDHOME.COM

FLOYD